



CHEMLINE 720 DIAPHRAGM VALVE

Installation Manual

MAINTENANCE INSTRUCTIONS For Chemline Position Indicator for 720 Series Diaphragm Valve Size 3/8" & 1/2"

Installation (all sizes)

Refer to **ASSEMBLY DRAWING 720** and proceed as follows:

NOTE: Isolate the valve from the pipeline before performing any maintenance.

1. From bottom of body (1), remove the bolts (12) to release the actuator portion.
2. Remove the body from the actuator. Inspect and replace if necessary.
3. Unscrew the process diaphragm (2) from the adaptor assembly (6).
4. Inspect and replace process diaphragm if necessary.
5. To re-assemble valve follow steps 1 through 4 in reverse order, tightening to the bolt torques recommended in the chart below.

IMPORTANT When re-assembling valve ensure that holes in lower part of valve, diaphragm and cover are in line. When tightening diaphragm, if it stops turning before its tab lines up with that on the actuator, unscrew diaphragm totally until it backs off one screw thread, then retighten. The tab should now line up with that on the actuator. Also if attaching to actuator, ensure that all screw holes line up.

VALVE SIZE	DIAPHRAGM BOLT	MATERIAL TORQUE	(IN-LB)
	EPDM	Viton	Teflon
3/8	13	13	18
1/2	13	13	18

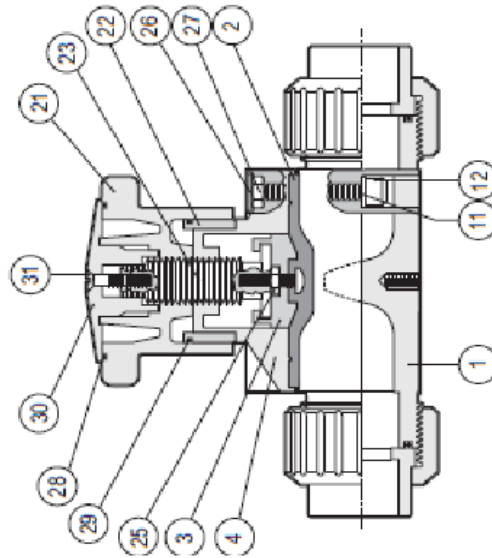

PARTS **4. Recommended Spare Parts**

No.	Part	Pcs.	Materials
1	Body	1	PVC, PP, PVDF CPVC
2▲	Diaphragm	1	EPDM, FKM-B (Viton®), PTFE
3	Compressor	1	PPS ¹
4	Bonnet	1	PPS ¹
11	Washer	4	304 SS
12	Socket Head Bolt	4	304 SS
21	Handwheel	1	PPS ¹
22	Position Indicator Collar	1	PVDF
23	Stem	1	304 SS
25	Hex Nut	1	304 SS
26	Bolt Cap	4	POM
27	Hex Nut	4	304 SS
28	Handwheel O-Ring (upper)	1	FKM-B (Viton®)
29	Handwheel O-Ring (lower)	1	FKM-B (Viton®)
30	Handwheel Cap	1	PPS ¹
31	Handwheel Screw	1	304 SS

¹ PPS = Polyphenylene sulfide

TITLE CHEMLINE 720 SERIES DIAPHRAGM VALVE	SCALE		DATE		CHEMLINE PLASTICS 	DWG. NO. 720	REV.
	DR. BY						
	CHKD BY						
	APP. BY						
REFERENCE 3/8" & 1/2"							